

SHAFT LEGENDS

LV	LOW VOLTAGE CABLE SHAFT
ELEC.	ELECTRICAL SHAFT
PL	PLUMBING SHAFT
LLPS	LIFT LOBBY PRESSURISATION SHAFT
FHC	FIRE HOSE CABINET
COW/SR	COLD WATER SUPPLY RETURN
CHW/SR	CHILLED WATER SUPPLY RETURN
COR. (FR)	CORRIDOR EXHAUST
COR. (EX)	CORRIDOR FRESH AIR
SPL. KIT. (EX)	SPECIALITY KITCHEN EXHAUST
TOL. (EX)	TOILET EXHAUST
ST (PR)	STAIRCASE PRESSURISATION SHAFT
PAN. (EX)	PANTRY EXHAUST
STP. (EX)	STP EXHAUST
DIS. KIT. (EX)	DISPLAY KITCHEN EXHAUST
KIT. TFA	KITCHEN TREATED FRESH AIR
KITCHEN (SR)	KITCHEN (SUPPLY) RETURN AIR
HOTEL BOH. (EX)	HOTEL BOH EXHAUST
KIT. (EX)	KITCHEN EXHAUST

- PROJECT CODE: 198-2021
- This Drawing and Design is the Property of the Designers. No Part may be used or reproduced without their Written Permission.
 - All Dimensions are to be Verified onsite by the Contractor. Any Discrepancies are to be Reported to the Designers Immediately.
 - The Drawing is to be Read in Connection with the Designers Specifications, Conditions of Contract and Relevant Consultant Drawings.
 - Drawings not Showing the Latest Revisions are to be Cancelled.
 - All Dimensions are to be Read not Scaled.
 - All Indicated Levels are Finishes Levels unless Noted Otherwise.
 - Architect is not responsible for any deviation in areas (i.e. built, structural, marketing etc.).
 - Any and All deviations from municipal drawings is understood to be made of behalf of client request with prior information provided to the client by architect about legal implications. Accepted in no way whatsoever can be held responsible for such deviations.

DOOR SCHEDULE

TYPE	WIDTH	HEIGHT	GLASS	MARKING	SWING
FD1	2000	2100	0	0	0
FD2	2000	2100	0	0	0
FD3	2000	2100	0	0	0
FD4	2000	2100	0	0	0
FD5	2000	2100	0	0	0
FD6	2000	2100	0	0	0
FD7	2000	2100	0	0	0
FD8	2000	2100	0	0	0
FD9	2000	2100	0	0	0
FD10	2000	2100	0	0	0
FD11	2000	2100	0	0	0
FD12	2000	2100	0	0	0
FD13	2000	2100	0	0	0
FD14	2000	2100	0	0	0
FD15	2000	2100	0	0	0
FD16	2000	2100	0	0	0
FD17	2000	2100	0	0	0
FD18	2000	2100	0	0	0
FD19	2000	2100	0	0	0
FD20	2000	2100	0	0	0

AREA STATEMENT
TOTAL F.A.R. ON SEVENTH FLOOR: 3368.26 SQM

SPECIAL NOTE:
THE BUILDING IS FULLY MECHANICALLY VENTILATED.

SKA Developers
S.K.A. Developers
Partner

ARCHITECT
SIGNATURE OF ARCHITECT

STRUCTURE
SIGNATURE OF STRUCTURAL ENGINEER
SAHIV J. VAREKH
M.E.(CONSTR.) M.E.(CONSTR. ENGR.)
B.C.E., F.I.E.(E-018202-A)
U.S.E. NO. 104(1) K.M.C.C.
STRUC/ENGR/7-27 S.M.C.

PROJECT
PLAN SHOWING: BASEMENT 1-BASEMENT 2-BASEMENT 3-BASEMENT 4
GROUND + FLOOR W/REAR USE
OFFICE-HOTEL-RETAIL-SHOPS-BALLROOM-MULTI-PLEX
BUILDING AT UTTORIAN TOWNSHIP, JALPAIGURI.

DRAWING TITLE
SA-1.11 - SEVENTH FLOOR PLAN

REVISIONS

REV. NO.	DATE	REMARKS

DRAWING STATUS
SANCTION

PROJECT: SA-1.11 SCALE: 1:200
STARTED: DATE: 22 NOV 2022
CHECKED: ADITYA SEAL PRASHANT
DRAWING NO. R2

May be Approved
District Engineer
Sibohit Mataram Panchayat
Dagupan, Dist. Dagupan

The Construction of the Building shall be supervised by the Architect, Surveyor/Architect, stalling the final application. Unless otherwise approved by the Authority the permission shall remain valid for a period of TWO YEARS.
Registration No. 17/2013/MFS
Permission Granted/Permission granted subject to the condition as hold in the ORDER Building Permit, before to be approved by the Matigara Panchayat Smitly, before the proposed construction undertaken

WIDE ORDER NO. 17/2013/MFS
DATE 10/13/2013

Sub Assistant Engineer (S.P.C.)
Matigara Development Block
Po. Kadamtala, Dt. Dagupan

APPROVE
Executive Officer
Matigara Panchayat Smitly
Po. Kadamtala, Dist. Dagupan

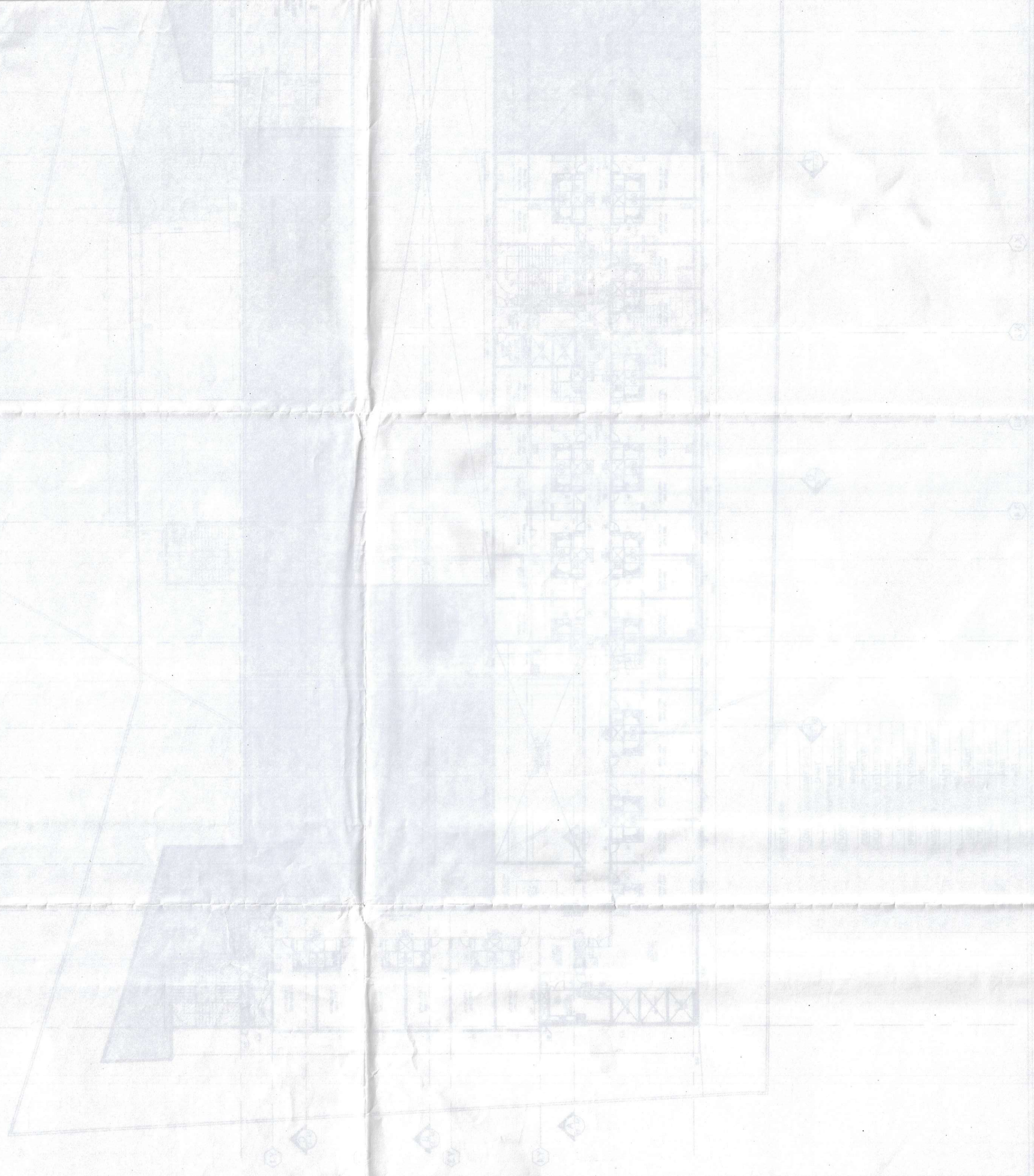

REMARKS
REVISIONS
DATE

SKK Development
Dagupan

PANGKALAN
PANGKALAN
PANGKALAN

REVISIONS
DATE

REVISIONS
DATE

REVISIONS
DATE

REVISIONS
DATE